

Pressure gauge with diaphragm Industry version with or without filling

Nominal size ND 100 , 160
Accuracy class 1,6 and 2,5

according to DIN EN 837-3

Features

High resistance to overpressure
Robust stainless steel case
Highly suitable for extremely viscous or
crystallizing media

Applications

Food and beverage industries,
Mechanical engineering, plant and
apparatus construction ,



Version	with glycerine filling			
Model and ND	MP-20 100	MP-20 160	MP-20 100 F	MP-20 160 F
Connection	bottom			
Accuracy class	1,6, ranges under 600 mbar with filling only Kl. 2,5			
Ranges	in mbar		0...40, 60, 100, 160, 250	
	in bar		0...0,4, 0,6, 1, 1,6, 2,5, 4, 6, 10, 16, 25	
	in bar		-0,6 / 0, -1 / 0, -1 / +0,6, -1 / +1,5, -1 / +3, -1 / +5, -1 / +9, -1 / +15	
Application	Constant load full scale value Alternating load 0,9 x full scale value Overload protection 1,3 x full scale value short time			
Case	CrNi steel	Steel black	CrNi steel	
Bezel	CrNi steel	Steel black	CrNi steel	
Window	Glas lens			Lamineted safety glass
Dial	Aluminium white, scale black			
Pointer	Aluminium, black			
Movement	Copper alloy ,bearing parts nickel silver			
Flangediameter	160 mm up to 250 mbar, 100 mm from 0,4 bar			
Measuring element	CrNi steel, from 2,5 bar Duratherm 600			
Lower flange	SW 22, Steel zincing			
Connection	G 1/2 B and DIN-flange DN 15, 20, 25 and 50, for all PN 40			
Protection	IP 54 according to EN 60529 / IEC 529		IP 54 according to EN 60529 / IEC 529	
Temperatures	Medium: -20°C to 100°C, Ambient: -25°C to 60°C			

Dimensions

Flange 100 mm

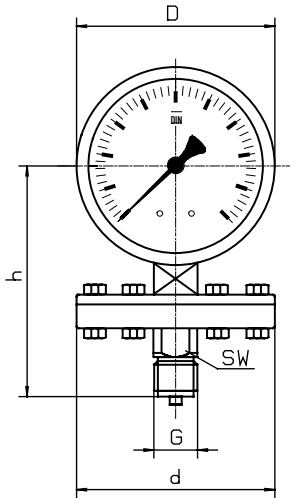

Flange 160 mm

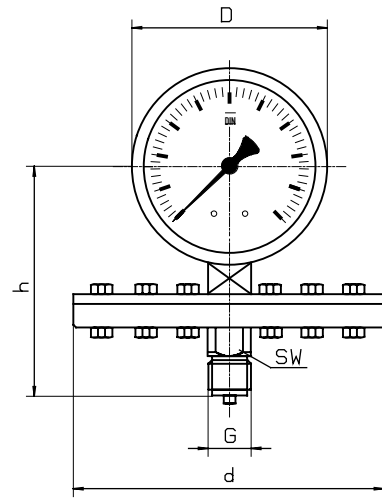

Flange according to DIN

Flange 100 mm

DN 25

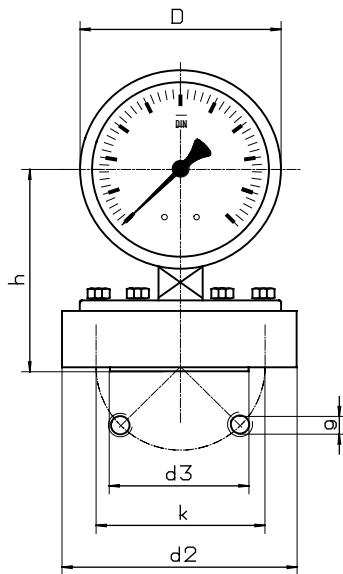

DN 50

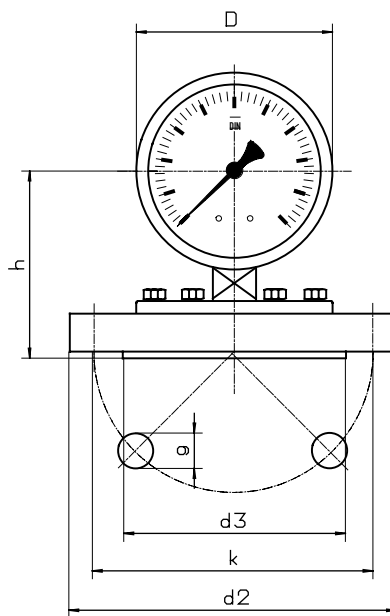

Flange 160 mm

DN 50

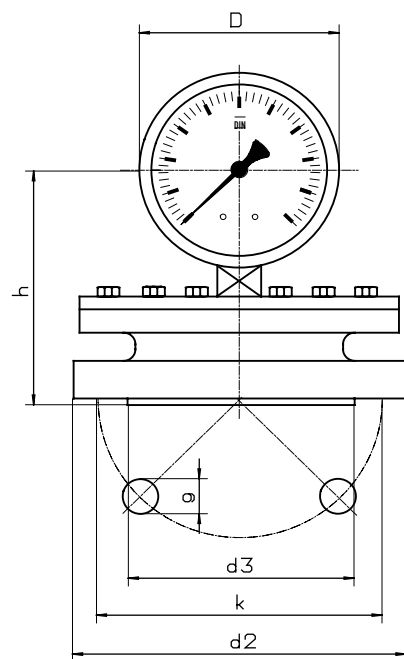

Modelspecification

Model
MP-2

Connection
0

bottom = 0

Filling

F or -

with filling = F
without filling =

Nominal size

100 or 160

Case ND 100 = 100
Case ND 160 = 160

Range

f.e. 10 bar

after rangespecification
or direkt 10 bar

Options

for example
f.e. DIN-flange DN 50

Dimensionstable lock at data sheet M 590

Contact pressure gauges with diaphragm Industry version , with or without filling

Nominal size 100 , 160
Accuracy class 1,6 and 2,5

according to DIN EN 837-3

Features

High resistance to overpressure
Robust stainless steel case
Highly suitable for extremely viscous or crystallizing media

Applications

Food and beverage industries,
Mechanical engineering, plant and apparatus construction ,



Version	with silicon oil filling			
Model and ND	KMP-20 100	KMP-20 160	KMP-20 100 F	KMP-20 160 F
Connection	bottom			
Accuracy class	1,6, ranges under 600 mbar with filling only Kl. 2,5			
Ranges	in mbar 0...60, 100, 160, 250, 400 in bar 0...0,6, 1, 1,6, 2,5, 4, 6, 10, 16, 25 in bar -0,6 / 0, -1 / 0, -1 / +0,6, -1 / +1,5, -1 / +3, -1 / +5, -1 / +9, -1 / +15			
Application	Constant load full scale value Alternating load 0,9 x full scale value Overload protection 1,3 x full scale value short time			
Case	CrNi steel	Steel black	CrNi steel	
Bezel	CrNi steel	Steel black	CrNi steel	
Window	Polycarbonat			
Dial	Aluminium white, scale black			
Pointer	Aluminium, black			
Movement	Copper alloy ,bearing parts nickel silver			
Flangediameter	160 mm up to 250 mbar, 100 mm from 0,4 bar			
Measuring element	CrNi steel , from 2,5 bar Duratherm 600			
Lower flange	SW 22, Steel zincing			
Connection	G 1/2 B and DIN-flange DN 15, 20, 25 and 50, for all PN 40			
Protection	IP 54 according to EN 60529 / IEC 529		IP 65 according to EN 60529 / IEC 529	
Temperatures	Medium: -20°C to 100°C, Ambient: -25°C to 60°C			
Informations over magnet snap action contact and inductive contact see data sheets M 950 and 960				

SUCHY MESSTECHNIK

Garnsdorfer Hauptstraße 116, D-09244 Lichtenau Telefon: 037208/66580 Fax: 037208/66582
e-Mail: suchy@suchy-messtechnik.de

Dimensions

Flange 100 mm

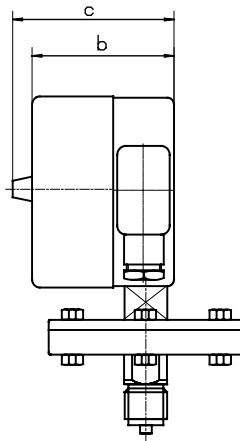
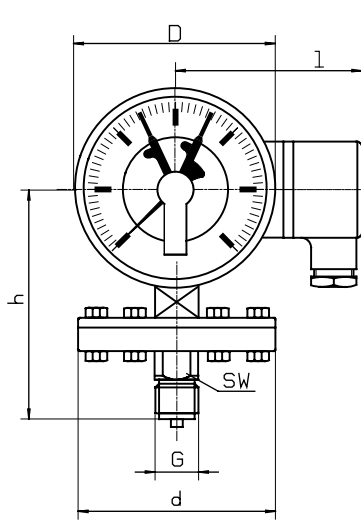

Flange 160 mm

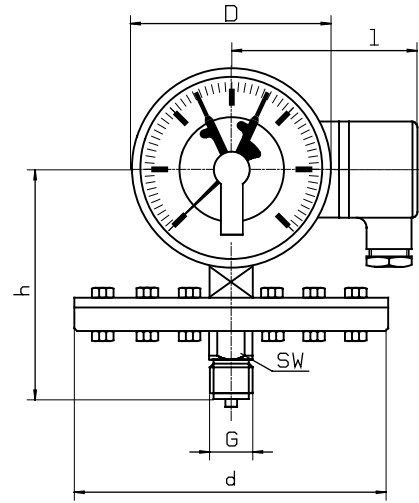

Flange according to DIN

Flange 100 mm

DN 25

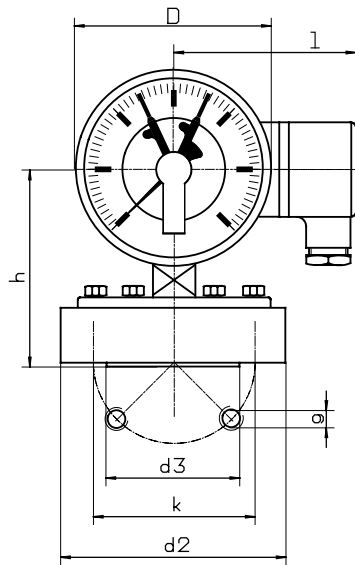

DN 50

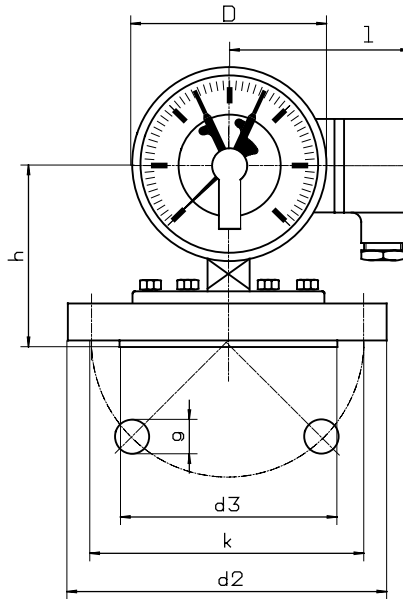

Flange 160 mm

DN 50

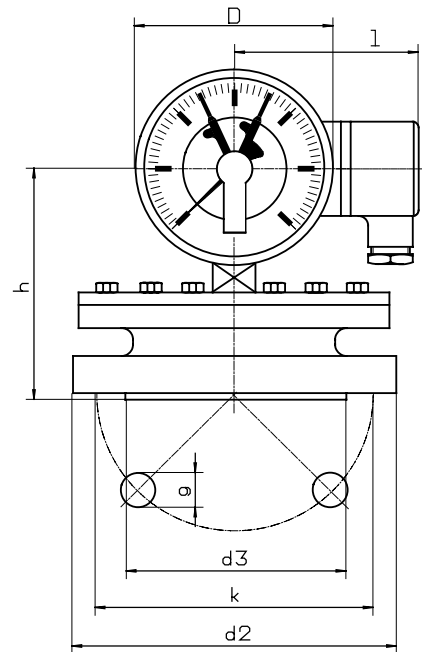

Modelspecification

Model
KMP-2

Connection
0

bottom = 0

Filling

F or -

with filling = F
without filling =

Nominal size

100 or 160

Case ND 100 = 100
Case ND 160 = 160

Range

f.e. 10 bar

Contact after specification

Options

f.e. M 12

Contact closes/opens
other versions
f.e. DIN flange DN 50

after rangespecification
or direkt 10 bar

Dimensionstable lock at data sheet M 590

Pressure gauges with diaphragm Stainless steel , with or without filling

Nominal size ND 100 , 160
Accuracy class 1,6 and 2,5

according to DIN EN 837-3

Features

- High resistance to overpressure
- High corrosion resistance with chemically aggressive media and environments
- Damping of the indicator by glycerine filling

Applications

- Chemical and petrochemical industry
- Food and beverage industry
- Mechanical engineering ,plant and apparatus construction



Version	with glycerin filling			
Model and ND	MP-30 100	MP-30 160	MP-30 100 F	MP-30 160 F
Connection	bottom			
Accuracy class	1,6, Ranges < 400 mbar with glycerine filling 2,5			
Ranges in mbar	0...10, 16, 25, 40, 60, 100, 160, 250		0...40, 60, 100, 160, 250	
in bar	0...0,4, 0,6, 1, 1,6, 2,5, 4, 6, 10, 16, 25			
in bar	-0,6 / 0, -1 / 0, -1 / +0,6, -1 / +1,5, -1 / +3, -1 / +5, -1 / +9, -1 / +15			
Application	Constant load full scale value Alternating load 0,9 x full scale value Overload protection 1,3 x full scale value short time			
Case	CrNi steel			
Bezel	CrNi steel			
Window	Laminated safety glass			
Dial	Aluminium white, scale black			
Pointer	Aluminium, black			
Movement	CrNi steel			
Flangediameter	160 mm up to 250 mbar, 100 mm from 0,4 bar			
Measuring element	CrNi steel , from 2,5 bar Duratherm 600			
Lower flange	SW 22, CrNi steel			
Connection	G 1/2 B and DIN-flange DN 15, 20, 25 and 50, for all PN 40			
Protection	IP 54 according to EN 60529 / IEC 529		IP 65 according to EN 60529 / IEC 529	
Temperatures	Medium: -20°C to 100°C, Ambient: -25°C to 60°C			

Dimensions

Flange 100 mm

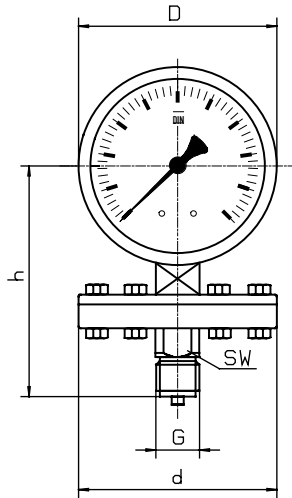

Flange 160 mm

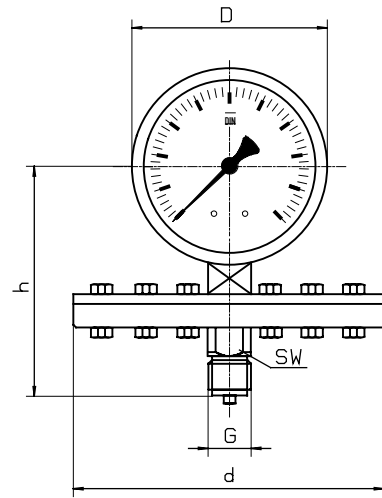

Flange according to DIN

Flange 100 mm

DN 25

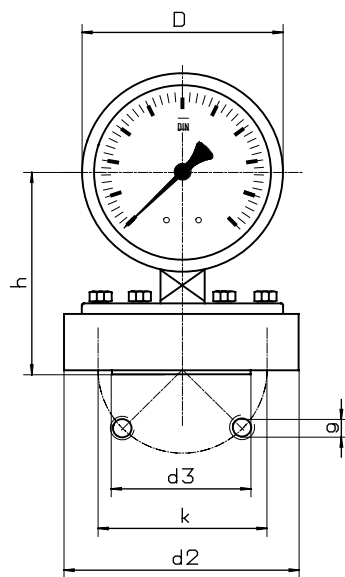

DN 50

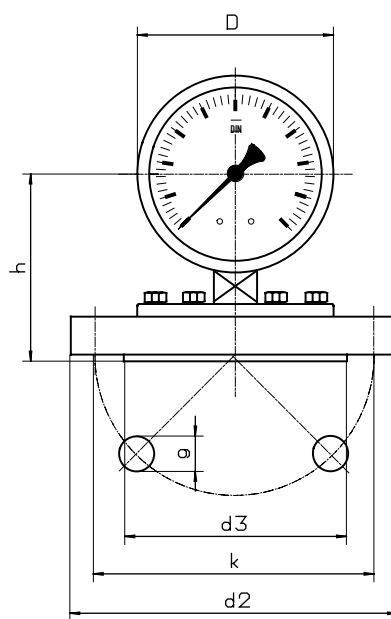

Flange 160 mm

DN 50

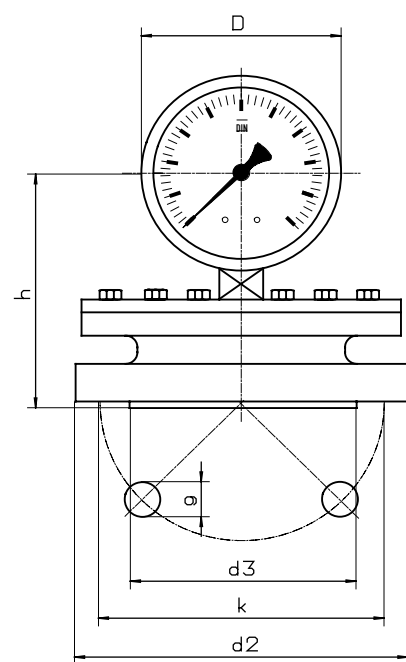

Modelspecification

Model
MP-3

Connection
0

bottom = 0

Filling

F or -

with filling = F
without filling =

Nominal size

100 or 160

Case ND 100 = 100
Case ND 160 = 160

Range

f.e. 10 bar

after rangespecification
or direkt 10 bar

Options

for example
z.B. DIN-Flansch DN 50

Dimensionstable lock at data sheet M 590

Dimensions

Flange 100 mm

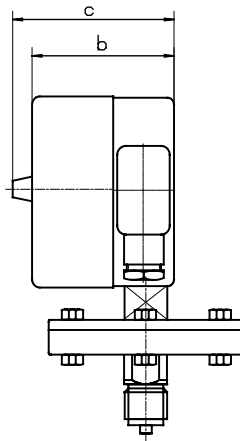
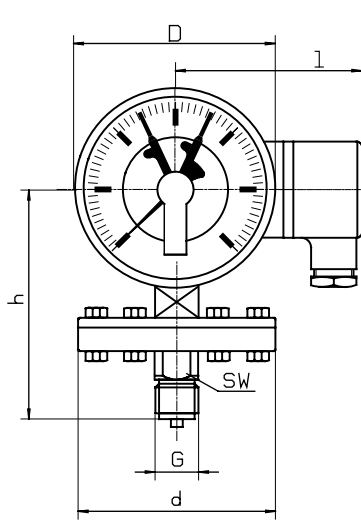

Flange 160 mm

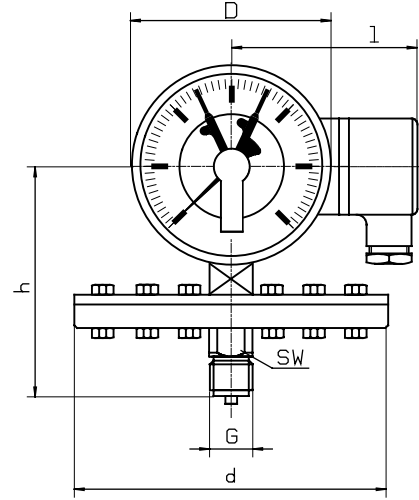

Flange according to DIN

Flange 100 mm

DN 25

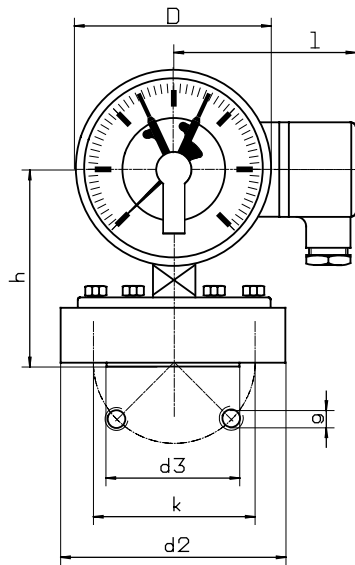

DN 50

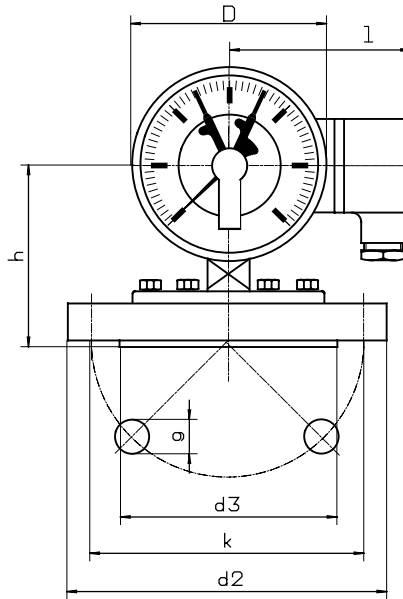

Flange 160 mm

DN 50

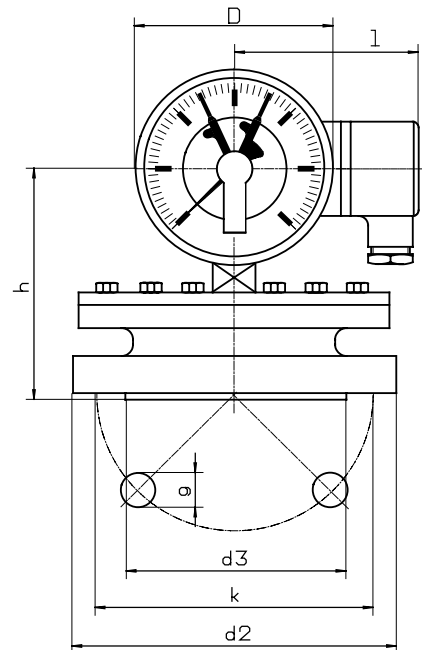

Modelspecification

Model
KMP-3

Connection
0

bottom = 0

Filling

F or -

with filling = F
without filling =

Nominal size

100 or 160

Case ND 100 = 100
Case ND 160 = 160

Range

f.e. 10 bar

Contact after specification

Options

f.e. M 12

Contact closes/opens
other versions
f.e. DIN flange DN 50

after rangespecification
or direkt 10 bar

Dimensionstable lock at data sheet M 590